

REQUEST FOR REVISION TO THE ZONING MAP
ONE FORM PER TRACT/LOT OF LAND
PLEASE REVIEW INSTRUCTIONS PRIOR TO SUBMITTING AN APPLICATION

PLEASE PRINT ALL

<p>1. <u>Kevin/Amanda Olesen & Jeremiah Griffitt</u> Name – Property Owner <u>750 S. Craigview Drive</u> Address <u>Harrisburg Mo 65256</u> City State Zip <u>Mantical172000@yahoo 573-808-0224</u> Owner Email Address Phone</p>	<p><u>Amanda/& Kevin Olesen & Jeremiah Griffitt</u> Potential Buyer/Lessee <u>750 S. Craigview Drive</u> Address <u>Harrisburg Mo 65256</u> City State Zip <u>573-808-0224</u> Buyer/Lessee Email Address Phone</p>
---	---

2. Legal description of land for which revision to zoning map application is made. Please attach copy of Warranty Deed, Deed of Trust, or survey.

Section 13 Township 50 Range 14 Parcel #: 05 600 13 004 004 00
Survey in Book 432, Page 734 05-600-13-00-004.01

3. Present zoning and actual land use: Recreational 2 livable dwellings on intire site. No Agriculral use observed at this time.

A portion of property is zoned A2.

4. Lot/tract size: 22.52 Acres / Sq. Ft. 5. Requested zoning district: A2 6. Adjacent zoning A2

7. Proposed use should the request to rezone be approved or, if revising a previously approved plan, explain proposed change: (Please be as detailed as possible, do not state "see plan")
No immediate changes. Possibly new home in the future.

8. Reason and justification for the request being submitted: Conveying property to different family members after deaths of Parents/Grandparents.

9. Approximate size, use and location of any structure(s): Include sketch.
Existing: 2 Mobile Homes 1380 Sq/ft each Proposed: No immediate changes

10. Type of wastewater system: Lagoons

11. Date of Concept Review, if known, (If no concept review was held, state "None"): None

- REQUIRED WITH INITIAL SUBMITTAL:** (ADDITIONAL DOCUMENTATION MAY BE REQUIRED AT A LATER DATE)
- Application FEE of \$350.00, or current fee (Non-refundable)
 - Copy of recorded Warranty Deed, Deed of Trust, or survey showing proof of ownership
 - List of property owners within 1000 feet of property (you may obtain from Assessor's Office)
 - If requesting Planned Zoning, a Review Plan fee of \$275.00 in addition to the \$350 application fee (Non-refundable)
 - If requesting Planned Zoning, all documentation required in Zoning Regulations Section 6.4
 - Additional Fees will be billed later including: Certified Mailings of \$6.80 per notice (or current cost) and Newspaper fees which must be paid by Friday the week prior to the scheduled meeting unless otherwise noted. Indicate below who will pay additional fees. Failure to pay these additional fees by the due date may result in the item being removed from the agenda.
 - Additional fees to be paid by Representative
 - Additional fees to be paid by Owner
 - Additional fees to be paid by Potential Buyer/Lessee

The above information is true and correct to the best of my knowledge

<u>[Signature]</u> Owner's Signature (REQUIRED)	<u>10-24-22</u> Date	<u>[Signature]</u> Potential Buyer's/Lessee's Signature	<u>10-24-22</u> Date
--	-------------------------	--	-------------------------

Representative: (Surveyor, Engineer, Attorney, Etc.)
Steven R. Proctor, 2000148666
Name
401 S. Cleveland
Address
Fayette, Mo 65248
City, State, Zip

Central Counties Surveying
Business/Company Name
660-728-5028
Office Phone Number
sproctor@centralcountiessurveying.net
Email Address

NOTE: Please attach any additional documentation, sketches, permits, names, and addresses as required as minimum information. Failure to provide any of the required material will result in the invalidation of the application. If you plan to show a power point or other digital presentation during the meeting(s) please provide staff a copy at least 24 hours in advance of the meeting date.

Received by: [Signature] Date 10/24/22
Boone County Planning and Building Inspections

10.47 AC OF 2

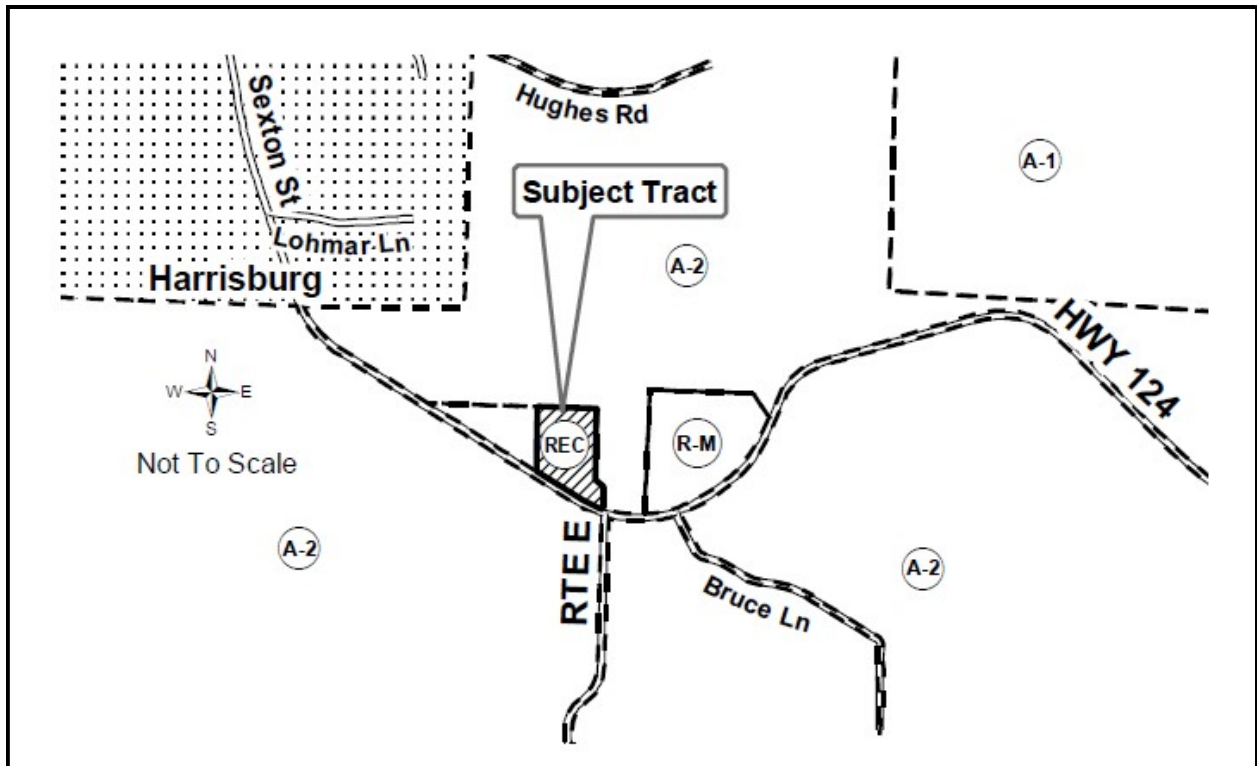

NOTICE OF PUBLIC HEARING BOONE COUNTY, MISSOURI

Notice is hereby given of a public hearing to be held before the Boone County Planning and Zoning Commission at 7:00 P.M. on Thursday, November 17, 2022 and before the Boone County Commission at 7:00 P.M. on Tuesday, November 29, 2022. Both hearings will be held in the Commission Chambers of the Roger B. Wilson Boone County Government Center, 801 E. Walnut St., Columbia, MO. The hearings will give all interested parties an opportunity to be heard in relation to the following:

Request by Kevin & Amanda Olesen & Jeremiah Griffitt to rezone from REC (Recreational) to A-2 (Agriculture) on 10.47 acres of a 22.53 acre tract located at 7495 W Hwy 124, Harrisburg.

The P & Z Commission meeting will also be available by phone, please check our website for additional details at www.showmeboone.com/resource-management

Questions regarding the above request may be directed to the Boone County Resource Management office at 886-4330.

Boone County Planning & Zoning Commission
Boyd Harris, Chairperson