

**REQUEST FOR REVISION TO THE ZONING MAP  
ONE FORM PER TRACT/LOT OF LAND  
PLEASE REVIEW INSTRUCTIONS PRIOR TO SUBMITTING AN APPLICATION**

PLEASE PRINT ALL

**1. D WHO LAND LLC**

Name – Property Owner  
8100 E. RICHLAND RD.  
Address  
COLUMBIA MO 65201  
City State Zip  
Owner Email Address Phone

Potential Buyer/Lessee  
Address  
City State Zip  
Buyer/Lessee Email Address Phone

2. Legal description of land for which revision to zoning map application is made. Please attach copy of Warranty Deed, Deed of Trust, or survey.

Section 13 Township 48 Range 12 Parcel #: 17 600 13 00 001 00 01  
+ 18-400-18-00-005.00

3. Present zoning and actual land use: A-1 AGRICULTURE

4. Lot/tract size: 145.72 Acres / Sq. Ft. 5. Requested zoning district: R-SP 6. Adjacent zoning A-1 / M-L

7. Proposed use should the request to rezone be approved or, if revising a previously approved plan, explain proposed change: (Please be as detailed as possible, do not state "see plan")

PLANNED SINGLE FAMILY RESIDENTIAL, 350 SINGLE FAMILY LOTS, 20 MULTI FAMILY LOTS

8. Reason and justification for the request being submitted: CURRENT A-1 ZONING DOES NOT ALLOW FOR MULTIPLE SINGLE FAMILY DWELLINGS, NOR MULTI FAMILY DWELLINGS.

9. Approximate size, use and location of any structure(s): Include sketch.

Existing: 3155 SQFT HOUSE, 3000 SQFT BARN Proposed: \_\_\_\_\_

10. Type of wastewater system: GRAVITY SEWER

11. Date of Concept Review, if known, (If no concept review was held, state "None"): 2/24/2021

**REQUIRED WITH INITIAL SUBMITTAL: (ADDITIONAL DOCUMENTATION MAY BE REQUIRED AT A LATER DATE)**

- Application FEE of \$350.00 (or current fee)
- Copy of recorded Warranty Deed, Deed of Trust, or survey showing proof of ownership
- List of property owners within 1000 feet of property (you may obtain from Assessor's Office)
- If requesting Planned Zoning, a Review Plan fee of \$275.00 (in addition to the \$350 application fee)
- If requesting Planned Zoning, all documentation required in Zoning Regulations Section 6.4
- Additional Fees will be billed later including: Certified Mailings of \$6.80 per notice (or current cost) and Newspaper fees which must be paid by Friday the week prior to the scheduled meeting unless otherwise noted. Indicate below who will pay additional fees. Failure to pay these additional fees by the due date may result in the item being removed from the agenda.
- Additional fees to be paid by Representative
- Additional fees to be paid by Owner
- Additional fees to be paid by Potential Buyer/Lessee

The above information is true and correct to the best of my knowledge.

James H. Hensch 2-22-2022  
Owner's Signature (REQUIRED) Date Potential Buyer's/Lessee's Signature Date

Representative: (Surveyor, Engineer, Attorney, Etc.)

**KEENAN SIMON**  
Name  
210 PARK AVE,  
Address  
COLUMBIA, MO 65203  
City, State, Zip

Business/Company Name  
Office Phone Number  
Email Address

NOTE: Please attach any additional documentation, sketches, permits, names, and addresses as required as minimum information. Failure to provide any of the required material will result in the invalidation of the application. If you plan to show a power point or other digital presentation during the meeting(s) please provide staff a copy at least 24 hours in advance of the meeting date.

Received by: Keenan Simon Date 2/22/22  
Boone County Planning and Building Inspections

FILED

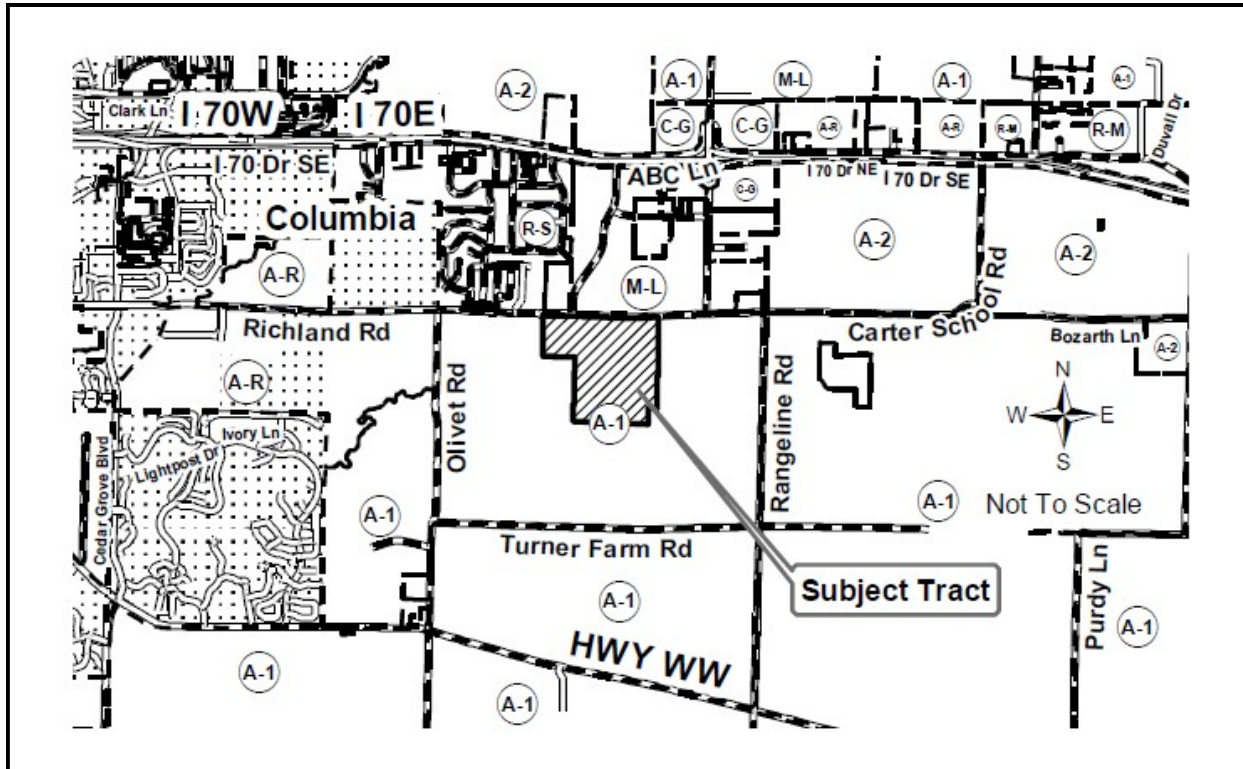

## NOTICE OF PUBLIC HEARING BOONE COUNTY, MISSOURI

Notice is hereby given of a public hearing to be held before the Boone County Planning and Zoning Commission at 7:00 P.M. on Thursday, April 21, 2022 and before the Boone County Commission at 7:00 P.M. on Tuesday, May 3, 2022. Both hearings will be held in the Commission Chambers of the Roger B. Wilson Boone County Government Center, 801 E. Walnut St., Columbia, MO. The hearings will give all interested parties an opportunity to be heard in relation to the following:

**Request by D Who Land LLC to rezone from A-1 (Agriculture) to R-SP (Planned Single Family Residential) and to approve a review plan for Five Pines on 145.72 acres located at 8100 E Richland Road, Columbia.**

The P & Z Commission meeting will also be available by phone, please check our website for additional details at [www.showmeboone.com/resource-management](http://www.showmeboone.com/resource-management)

Questions regarding the above request may be directed to the Boone County Resource Management office at 886-4330.

Boone County Planning & Zoning Commission  
Boyd Harris, Chairperson