

ADDENDUM NUMBER TWO

DATE: AUGUST 17, 2006

General: This Addendum is incorporated into the Contract Documents for the Project referenced below.

ARCHITECTURAL ITEMS (CSI DIVISIONS 0 THROUGH 14)

ACCEPTED PRODUCT/MANUFACTURER SUBSTITUTIONS

None this Addendum.

GENERAL CLARIFICATIONS

10 None this Addendum.

CHANGES TO THE SPECIFICATIONS

15 Section 01100, Summary, Lines 46-49: The waste dumpster shall be located north of the maintenance drive on the courthouse lawn, in lieu of the south side of the drive.

20 Section 01210, Allowances, Lines 56-62: Revise the text to the following: "Allowance No. One: Provide a materials only allowance of \$18.00 per square yard for carpet, direct-glue per Section 09680 - Carpet. The allowance shall cover the cost to the subcontractor of the materials only. Furnish vendor invoices upon request. The allowance shall not include the cost for freight, delivery, taxes, unloading and handling on the site, labor, installation costs, overhead, profit, bonds and insurance, relative to the allowance item."

Section 09310, Ceramic Tile: Add this section per attached pages.

CHANGES TO THE DRAWINGS

30 Sheet A1.1, Detail 4: Provide cut-outs in glass window above reception cabinetry at Waiting 101, per attached drawing AD02.01.

35 Sheet A1.1, Ceiling Schedule: Revise note to the following: "Existing ceiling grid shall be painted white at Open Office #110. Match finish and color of new grid. Replace ceiling tiles."

PLUMBING, HVAC AND ELECTRICAL ITEMS (CSI DIVISIONS 15 AND 16)

Refer to attached pages prepared by Mechanical and Electrical Engineer.

40 ATTACHMENTS

Specification Section 09310 - Ceramic Tile

AD02.01 - Revision to Sheet A1.1

Mechanical and Electrical items from the Mechanical and Electrical Engineer.

45 END OF ADDENDUM NUMBER TWO

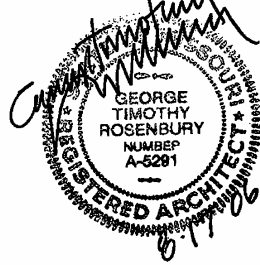

SECTION 09310 - CERAMIC TILE

PART 1 - GENERAL

RELATED DOCUMENTS

- 5 Drawings and general provisions of the Contract, including General and Supplementary Conditions and Division 1 Specification Sections, apply to this Section.

SUMMARY

This Section includes the following:

Ceramic mosaic tile.

SUBMITTALS

- 10 Product Data: For each product indicated.

Shop Drawings: Show locations of each type of tile and tile pattern. Show widths, details, and locations of expansion, contraction, control, and isolation joints.

- 15 Tile Samples for Initial Selection: Manufacturer's color charts consisting of actual tiles or sections of tiles showing the full range of colors, textures, and patterns available for each type and composition of tile indicated. Include Samples of accessories involving color selection.

- 20 Grout Samples for Initial Selection: Manufacturer's color charts consisting of actual sections of grout showing the full range of colors available for each type of grout indicated.

QUALITY ASSURANCE

- 25 Installer Qualifications: Engage an experienced installer who has completed tile installations similar in material, design, and extent to that indicated for this Project and with a record of successful in-service performance.

- 30 Source Limitations for Tile: Obtain each color, grade, finish, type, composition, and variety of tile from one source with resources to provide products from the same production run for each contiguous area of consistent quality in appearance and physical properties without delaying the Work.

- 35 Source Limitations for Setting and Grouting Materials: Obtain ingredients of a uniform quality for each mortar, adhesive, and grout component from a single manufacturer and each aggregate from one source or producer.

DELIVERY, STORAGE, AND HANDLING

Deliver and store packaged materials in original containers with seals unbroken and labels intact until time of use. Comply with requirement of ANSI A137.1 for labeling sealed tile packages.

- 40 Prevent damage or contamination to materials by water, freezing, foreign matter, and other causes.

- 45 Handle tile with temporary protective coating on exposed surfaces to prevent coated surfaces from contacting backs or edges of other units. If coating does contact bonding surfaces of tile, remove coating from bonding surfaces before setting tile.

PROJECT CONDITIONS

Environmental Limitations: Do not install tile until construction in spaces is completed and ambient temperature and humidity conditions are being maintained to comply with referenced standards and manufacturer's written instructions.

60

EXTRA MATERIALS

Furnish extra materials described below that match products installed and that are packaged with protective covering for storage and identified with labels describing contents.

55

Tile and Trim Units: Furnish quantity of full-size units equal to 3 percent of amount installed for each type, composition, color, pattern, and size indicated.

PART 2 - PRODUCTS

TILE PRODUCTS

- 60 Basis-of-Design Product: The Drawings indicate the basis-of-design product for the ceramic tile required for this project. Subject to compliance with requirements, provide either the named product or a comparable product by one of the other manufacturers specified below. For ceramic tile products that are not designated with a basis-of-design product, provide products by one of the following manufacturers.

65

Manufacturers:

American Olean, Div. of Dal-Tile International Corp.
Dal-Tile, Div. of Dal-Tile International Inc.
Florida Tile Industries, Inc.
Winburn Tile Manufacturing Company.

70

ANSI Ceramic Tile Standard: Provide Standard grade tile that complies with ANSI A137.1, "Specifications for Ceramic Tile," for types, compositions, and other characteristics indicated.

75

Unglazed and Glazed Ceramic Mosaic Tile: Factory-mounted flat tile as follows:

Composition: Porcelain.

Module Size: 1 by 1 inch (25.4 by 25.4 mm) and 2 by 2 inches (50.8 by 50.8 mm).

80

Thickness: 1/4 inch (6.35 mm).

Face: Plain with cushion edges.

Colors: Per Drawings.

SETTING AND GROUTING MATERIALS

Manufacturers:

85

Bonsal, W. R., Company.
Bostik.
Custom Building Products.
DAP, Inc.

90

LATICRETE International Inc.
MAPEI Corporation.
Southern Grouts & Mortars, Inc.
Summitville Tiles, Inc.
TEC Specialty Products Inc.

Latex-Portland Cement Mortar (Thin Set): ANSI A118.4.

Prepackaged dry-mortar mix combined with liquid-latex additive.

For wall applications, provide nonsagging mortar.

5 Chemical-Resistant, Water-Cleanable, Tile-Setting and -Grouting Epoxy: ANSI A118.3.

Organic Adhesive: ANSI A136.1, Type I.

Standard Unsanded Cement Grout: ANSI A118.6, color as indicated.

MISCELLANEOUS MATERIALS

10 Elastomeric Sealants: Elastomeric sealants of base polymer and characteristics indicated that comply with applicable requirements in Division 7 Section "Joint Sealants."

15 One-Part, Mildew-Resistant Silicone: ASTM C 920; Type S; Grade NS; Class 25; Uses NT, C, A, and, as applicable to nonporous joint substrates indicated, O; formulated with fungicide, intended for in-service exposures of high humidity and extreme temperatures.

Products:

20 Dow Corning Corporation; Dow Corning 786.
GE Silicones; Sanitary 1700.
Pecora Corporation; Pecora 898 Sanitary Silicone Sealant.
Tremco, Inc.; Tremsil 600 White.

25 Multipart, Pourable Urethane Sealant for Use T: ASTM C 920; Type M; Grade P; Class 25; Uses T, M, A, and, as applicable to joint substrates indicated, O.

Products:

30 Bostik; Chem-Calk 550.
Mameco International, Inc.; Vulkem 245.
Pecora Corporation; NR-200 Urexpam.
Tremco, Inc.; THC-900.

Trowelable Underlayments and Patching Compounds: Latex-modified, portland cement-based formulation provided or approved by manufacturer of tile-setting materials.

35 Metal Edge Strips: Angle or L-shape, stainless steel; ASTM A 666, 300 Series exposed-edge material.

Grout Sealer: Manufacturer's standard silicone product for sealing grout joints that does not change color or appearance of grout.

PART 3 - EXECUTION

PREPARATION

40 Remove coatings, including curing compounds and other substances that contain soap, wax, oil, or silicone, that are incompatible with tile-setting materials.

45 Fill cracks, holes, and depressions with trowelable leveling and patching compound according to tile-setting material manufacturer's written instructions.

Remove protrusions, bumps, and ridges by sanding or grinding.

Blending: For tile exhibiting color variations, use factory blended tile or blend tiles at Project site before installing.

50 Field-Applied Temporary Protective Coating: Where indicated under tile type or needed to prevent grout from staining or adhering to

exposed tile surfaces, precoat them with continuous film of temporary protective coating, taking care not to coat unexposed tile surfaces.

INSTALLATION, GENERAL

55 ANSI Tile Installation Standards: Comply with parts of ANSI A108 Series "Specifications for Installation of Ceramic Tile" that apply to types of setting and grouting materials and to methods indicated in ceramic tile installation schedules.

60 TCA Installation Guidelines: TCA's "Handbook for Ceramic Tile Installation." Comply with TCA installation methods indicated in ceramic tile installation schedules.

65 Extend tile work into recesses and under or behind equipment and fixtures to form complete covering without interruptions, unless otherwise indicated. Terminate work neatly at obstructions, edges, and corners without disrupting pattern or joint alignments.

70 Accurately form intersections and returns. Perform cutting and drilling of tile without marring visible surfaces. Grind cut edges of tile abutting trim, finish, or built-in items. Fit tile closely to electrical outlets, piping, fixtures, and other penetrations so plates, collars, or covers overlap tile.

75 Jointing Pattern: Lay tile in grid pattern, unless otherwise indicated. Align joints when adjoining tiles on floor, base, walls, and trim are same size. Lay out tile work and center tile fields in both directions in each space or on each wall area. Adjust to minimize tile cutting. Provide uniform joint widths, unless otherwise indicated.

Expansion Joints: Locate expansion joints and other sealant-filled joints during installation of setting materials, mortar beds, and tile. Do not saw-cut joints after installing tiles.

80 Locate joints in tile surfaces directly above joints in concrete substrates.

Prepare joints and apply sealants to comply with requirements in Division 7 Section "Joint Sealants."

Grout tile to comply with requirements of ANSI A108.10, unless otherwise indicated.

85 For chemical-resistant epoxy grouts, comply with ANSI A108.6.

90 Install waterproofing to comply with ANSI A108.13 and waterproofing manufacturer's written instructions to produce waterproof membrane of uniform thickness bonded securely to substrate.

For installations indicated below, follow procedures in ANSI A108 Series tile installation standards for providing 95 percent mortar coverage.

95 Tile floors composed of tiles 8 by 8 inches (200 by 200 mm) or larger.

Tile floors composed of rib-backed tiles.

Metal Edge Strips: Install at locations indicated or where exposed edge of tile flooring meets carpet, wood, or other flooring that finishes flush with top of tile.

100 Install tile on walls with the following joint widths:

Ceramic Mosaic Tile: 1/16 inch (1.6 mm).

Apply grout sealer to cementitious grout joints in tile floors according to grout-sealer manufacturer's written instructions. As soon as grout

sealer has penetrated grout joints, remove excess sealer and sealer that has gotten on tile faces by wiping with soft cloth.

FLOOR TILE INSTALLATION SCHEDULE

Interior floor installation on concrete; thin-set mortar; TCA F113.

- 5 Thin-Set Mortar: Latex-portland cement mortar.
- Grout: Standard unsanded cement grout.

END OF SECTION 09310

KEYNOTES

- 08.006 PROVIDE 3-1/2" DIAMETER HOLE IN GLASS WITH 1/2" GROMMET RING.
- 08.007 PROVIDE 14" X 3-1/2" PASS-THRU HOLE IN GLASS WITH 1" RADIUSED CORNERS AND 1/2" ALUMINUM EDGING.

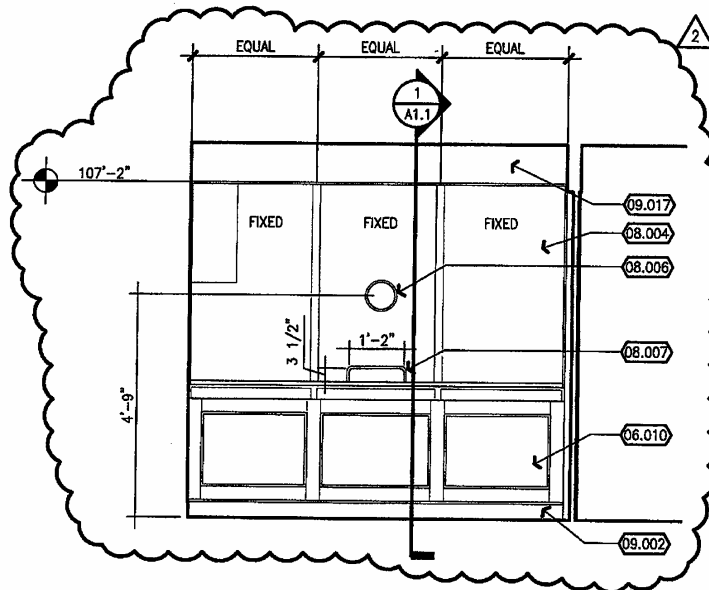

4 CABINETRY @ WAITING #101
SCALE : 3/8" = 1'-0"

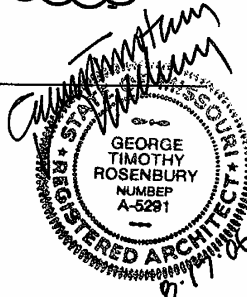

BOONE COUNTY COURTHOUSE RENOVATIONS

COLUMBIA, MISSOURI

06082.BOC2

ISSUE DATE: August 17, 2006

REVISION TO SHEET: A1.1

AD02.01

BUTLER, ROSENBURY & PARTNERS, INC. • 319 N. Main, Ste 200 • Springfield, MO. 65806 • Ph.(417)865-6100 • Fx.(417)865-6102 • www.brpa.com

COPYRIGHT © 2006 BUTLER, ROSENBURY & PARTNERS, INC.

MECHANICAL AND ELECTRICAL ITEMS

DATE: August 17, 2006

General: This addendum is incorporated into the Contract Documents for the Project referenced below.

PLUMBING AND HVAC ITEMS (DIVISION 15)

ACCEPTED PRODUCT/MANUFACTURER SUBSTITUTIONS:

Nailor shall be approved for fan terminal units and VAV boxes.

GENERAL CLARIFICATIONS:

None this addendum

CHANGES TO THE SPECIFICATIONS:

None this addendum

CHANGES TO THE DRAWINGS:

1. Refer to revised sheet M2, "Grilles, Registers, & Diffuser Schedule".

- a) Types "A" and "B" shall be changed as indicated on the attached sheet AD2-M2-1. Only high induction, low temperature, linear diffusers shall be allowed.

ELECTRICAL ITEMS (DIVISION 16)

ACCEPTED PRODUCT/MANUFACTURER SUBSTITUTIONS:

None this addendum

GENERAL CLARIFICATIONS:

None this addendum

CHANGES TO THE SPECIFICATIONS:

None this addendum

CHANGES TO THE DRAWINGS:

None this addendum

END OF ADDENDUM

Terrence Patrick Marshall
8/17/06

GRILLES, REGISTERS & DIFFUSER SCHEDULE

MARK	MANUFACTURER	CATALOG #	APP	FINISH	FRAME TYPE	VOLUME DAMPER	MAX. IN. (DB)	MIN. THROW (FT)	MAX. THROW (FT)	MAX. PRESS. DROP
A	THERMAL CORE	HILT-24"-2 WAY STANDARD CAPACITY	SUP	WHITE	T-BAR	NO	.25	8	21	0.2"
B	THERMAL CORE	HILT-48"-2 WAY STANDARD CAPACITY	SUP	WHITE	T-BAR	NO	.25	11	20	0.2"
C	TITUS	PAR 24x24-3	RET	WHITE	T-BAR	NO	.25	-	-	0.08"
D	TITUS	PAR 12x12-3	RET/EXH	WHITE	T-BAR	NO	.25	-	-	0.08"

ABBREVIATIONS:
 EXH - EXHAUST
 RET - RETURN
 SUP - SUPPLY

NOTES:
 THROWS ARE BASED ON 50 FEET PER MINUTE VELOCITY.



 Consulting Engineers
 2040 East Sunshine
 Springfield, Missouri 65804
 phone 417.881.0020
 fax 417.881.0053
 mfec.com
 Madison Fink, Boardman & Collins, Inc.

PROJECT
**BOONE COUNTY
 COURTHOUSE REMODEL
 COLUMBIA, MISSOURI**

DATE
08/17/06
 PROJECT NUMBER
14523-06
 SHEET NUMBER
AD2-M2-1