

**CONTRACT DOCUMENTS
BOONE COUNTY, MISSOURI
BID NO: 45-14JUL05 – Lake of the Woods**

ADDENDUM #1
(Issued July 8, 2005)

This addendum is issued in accordance with the Introduction and General Conditions of Bidding and is hereby incorporated into and made a part of the Contract Documents. Bidders are reminded that receipt of this addendum should be acknowledged and submitted with bidder's *Response Form*.

Specifications for the above noted Request for Bid and the work covered thereby are herein modified as follows, and except as set forth herein, otherwise remain unchanged and in full force and effect:

BID DOCUMENTS:

1. Bid Opening Location Change: On Sheet 1.1 Notice to Bidders delete "Bids will be publicly opened after 1:30 p.m. on Thursday, July 14, 2005, in the Boone County Commission Chambers, Boone County Government Center, 801 East Walnut, Columbia, Missouri 65201" and replace with "**Bids will be publicly opened at 1:30 p.m. on Thursday, July 14, 2005, in the Boone County Johnson Building, Conference Room 213, 601 E. Walnut Street, Columbia, MO 65201.**"
2. Delete **Sheets 5.1 and 5.2 (Bid Forms)** of the Bid Documents in their entirety, and add the attached **Sheets 5.1 and 5.2 (Revised Bid Forms)**. Attach Revised Bid Form Sheets to the inside front cover of the Bid Documents.
3. Pipe Material Change: The Ultra FLO smooth wall aluminized steel pipe shown on sheet 4 of the plans has been replaced with Polymeric coated corrugated metal pipe (CMP) in accordance with Section 260 of the *Boone County, Missouri, Roadway Regulations*. See attached pipe flowline revision drawings.
4. Clarification: Revised Bid Item #13 Remove and Replace Unsuitable Subgrade shall include the removal of soft subgrade soils as directed by the Boone County Engineer following proof rolling of the subgrade. The soil shall be removed to the extents and depth directed by the Engineer. The unsuitable subgrade soil shall be removed from the site and legally disposed of. The excavation shall be filled with compacted 1 ½" minus base (rollstone). The maximum excavation depth for this work shall be 24 inches. Geotextile (Mirafi 6 oz. or approve equal) and geogrid (Tensar BX 1100 or approved equal) shall be installed in each area of removal and replacement as directed by the Engineer.
5. Pavement Joint Modification: The centerline joint keyway shown on Plan Sheet 6 in the Typical Cross Section and Type BS Keyed Construction Joint Detail shall not be required. The 30" long #4 rebar at 30" centers is still required.

45-14JUL05

6. The top 6 inches of soil subgrade shall be compacted to 90% maximum dry density. This work shall be included in the Excavation and Embankment bid item. Cut Compaction is no longer required.
7. All pavement repairs shall have 18" long #4 rebars epoxied 9" into the existing concrete at 30" centers on all sides. Interior joints in the pavement repair areas shall be in accordance with the standard concrete pavement joints shown on Plan Sheet 6.
8. Cross Section Clarification: Separate Concrete Curb and Gutter will be allowed. 30" #4 rebars at 30" centers will be required between the curb and gutter and adjacent pavement. Curb joints shall match pavement transverse joint spacing, maximum 12 feet.

By: 
Melinda Bobbitt, CPPB
Director of Purchasing

BIDDER has examined copy of Addendum #1 to Bid Number 545-14JUL05 – *Lake of the Woods Pavement and Drainage Improvements – Phase 1*, receipt of which is hereby acknowledged:

Company Name: _____

Address: _____

Phone Number: _____ Fax Number: _____

Authorized Representative Signature: _____ Date: _____

ADDENDUM #1 – REVISED BID FORM

BID FORM – Lake of the Woods Pavement and Drainage Improvements – Phase 1

Project Number 9809

BASE BID

Item	Description	Quantity	Unit	Unit Price	Extended Total
1	Mobilization and Bonds	1	LS	\$	\$
2	Construction Staking	1	LS	\$	\$
3	Traffic Control	1	LS	\$	\$
4	Removal of Improvements	1	LS	\$	\$
5	Excavation and Embankment	1	LS	\$	\$
6	6" Concrete Pavement (Main Line)	4487	SY	\$	\$
7	6" Concrete Driveway Pavement	502	SY	\$	\$
8	4" Type I Aggregate Base	4989	SY	\$	\$
9	Type M Inlet #1 4' x 3' x 8.1' Modified Throat	1	EA	\$	\$
10	Type M Inlet #2 4' x 3' x 5.3'	1	EA	\$	\$
11	18" Corrugated Metal Pipe (CMP) 16 GA.	57.5	LF	\$	\$
12	Type 2 Rip-Rap Blanket	2	CY	\$	\$
13	Remove and Replace Unsuitable Subgrade	150	CY	\$	\$
14	Fertilize, Seed, Mulch & Site Restoration	1	LS	\$	\$
15	Erosion Control Barrier	1	LS	\$	\$
BASE BID TOTAL					\$

45-14JUL05

ADDENDUM #1 – REVISED BID FORM

ALTERNATE #1 – Full Depth Concrete Pavement Repair

Item	Description	Quantity	Unit	Unit Price	Extended Total
16	Mobilization and Bonds	1	LS	\$	\$
17	Traffic Control	1	LS	\$	\$
18	Full Depth Concrete Pavement Repair	490	SY	\$	\$
19	6" Concrete Driveway Pavement	115	SY	\$	\$
20	Concrete Pavement Removal	605	SY	\$	\$
21	Fertilize, Seed, Mulch and Site Restoration	1	LS	\$	\$
22	Remove and Replace Unsuitable Subgrade	60	CY	\$	\$
ALTERNATE BID TOTAL					\$

NOTE: The Final Quantity of Pavement Repair performed under Alternate #1 will be determined based on budgetary constraints. More or less work may be performed. See Special Conditions.

ADDENDUM #1

LAKE OF THE WOODS PAVEMENT AND DRAINAGE IMPROVEMENTS - PHASE I

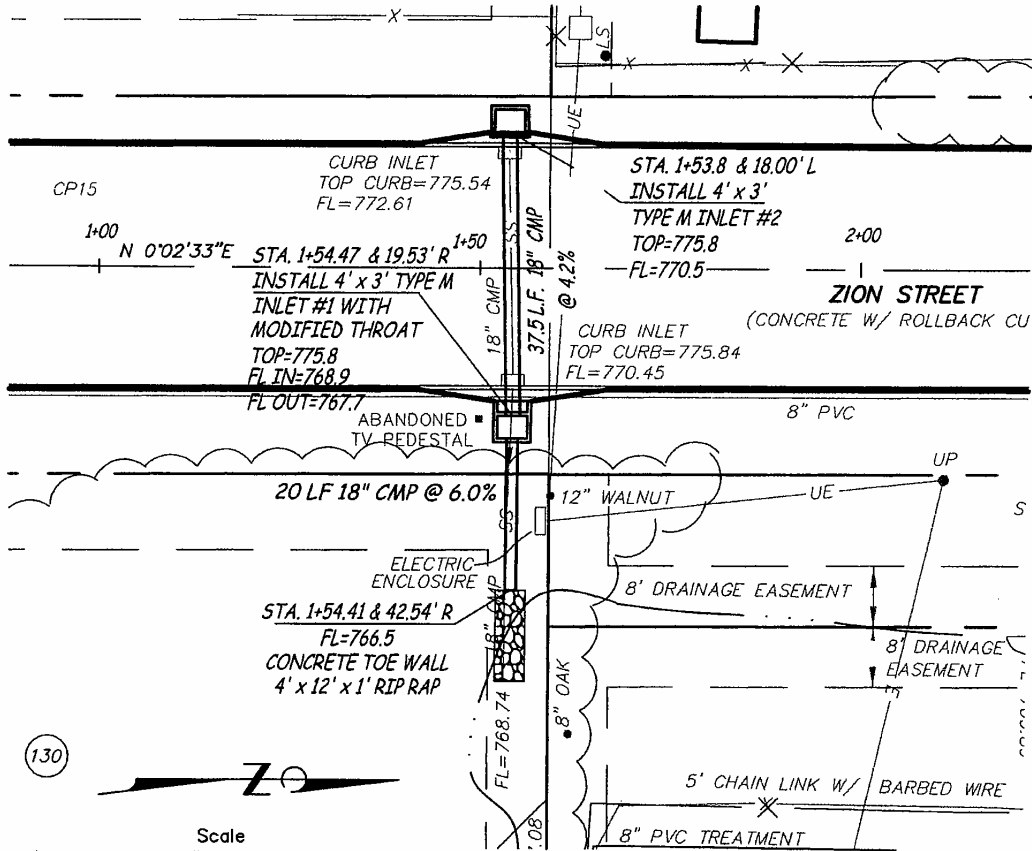

STATE OF MISSOURI
BENJAMIN A. ROSS
REGISTERED PROFESSIONAL ENGINEER
NUMBER E-30054
Benjamin A. Ross
6 July 2005



Engineering Surveys & Services

1113 Fay Street
Columbia, Missouri
573 - 449 - 2646

ADDENDUM #1

LAKE OF THE WOODS PAVEMENT AND DRAINAGE IMPROVEMENTS - PHASE I

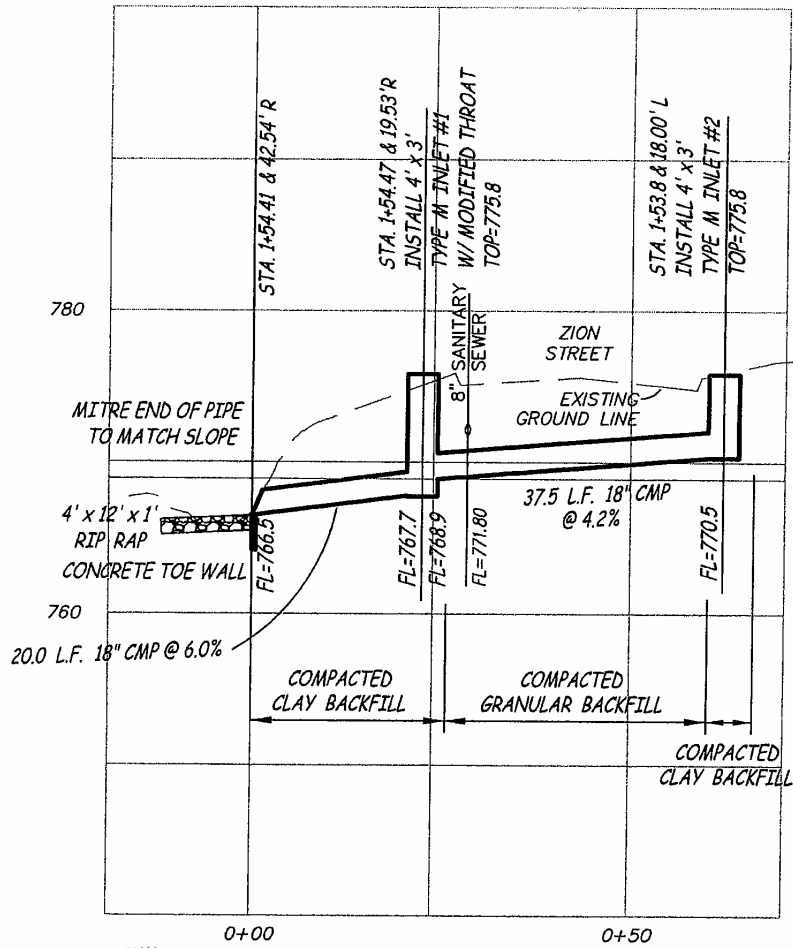

Scale
1" = 20' HORIZ.
1" = 10' VERT.

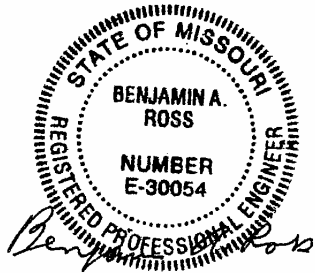

Engineering Surveys & Services

1113 Fay Street
Columbia, Missouri
573 - 449 - 2646